

# केन्द्रीयसंस्कृतविश्वविद्यालयः

श्रीरणवीरपरिसरः,

कोट-भलवालः, जम्मू-181122

संसदः अधिनियमेन स्थापितः

(प्राक्तनं राष्ट्रियसंस्कृतसंस्थानम्, मानितविश्वविद्यालयः)

भारतसर्वकारस्य शिक्षामन्त्रालयाधीनः

क्रमांक Csuj/Land/2020-21/ 1209

No.....To.....

Section Officer (Admn)  
Central Sanskrit University  
New Delhi



# CENTRAL SANSKRIT UNIVERSITY

Shri Ranbir Campus,

Kot- Bhalwal, Jammu-181122

Established by an Act of Parliament

(Formerly Rashtriya Sanskrit Sansthan, Deemed to be University)

Under Ministry of Education, Govt of India

दिनांक

Date 30.01.2021

**Subject: - Submission of total area of Campus land and cost.**

Sir

I am invite to your letter reference no. RSKS/Admn./Audit/2015 dated 13.07.2015 on the subject captioned above, the desired information are as under.

Land	: 84 Kanal 2 Marlas
Total Built up Area	: 9614.59 sq. mt.
Total Cost	: 2,78,370/-
Main Building	: Built up Area - 4798 sq.mt.
Library Building	: Built up Area - 1300 sq.mt.
Boys Hostel's Building 58 Rooms	: Built up Area - 1951.42 sq.mt.
Girls Hostel's Building 19 Rooms	: Built up Area - 934.17 sq.mt
Staff Quarters	: Built up Area - 631 sq.mt.

Your's Faithfully

(Prof. Madan Mohan Jha)  
Director

निदेशक / DIRECTOR -  
केन्द्रीय संस्कृत विश्वविद्यालय,  
CENTRAL SANSKRIT UNIVERSITY  
श्री रणवीर परिसर, कोट भलवाल जम्मू  
भारत सरकार, शिक्षा विभाग (केन्द्रीय संस्कृत संस्थान)

26 K. 10  
P. 28  
T1

Office of the Tehsildar Jammu.

To

The Principal  
Shri Ranbir Kendria Sanskrit,  
Vidya Peeth,  
Jammu.

Subject : Requisition of piece of land at village Ehalwal  
for construction of Campus of Jammu Vidya Peeth.

Sir,

Please refer to your letter No. SRKSV/20012/2056  
dated 2-11-1989 on the subject cited above.

It is certified that as per the report of the  
Patwari in pursuance of award issued by the Collector  
Jammu, the possession of the land measuring 84 Kanals  
2 marlas comprising of Khasra Nos. 2740, 2741, 2746, 2649  
2747, 2750, 2750, 2750, 2652, 2654 situated at village  
Ehalwal Tehsil Jammu has been handed over to the Principal,  
Shri Ranbir Kendria Sanskrit Vidya Peeth, Jammu through  
Nishandehi.

No. - 2672/02  
dt. - 28-11-89

Yours faithfully,

  
Tehsildar  
Jammu.



A WARD

*R.O. 1066/1990  
29/7/85*

On receipt of formal indent from Director Rashtriya Sanskrit Sansthan, Delhi vide his letter No. F-35017/71/Asp/1307 dated 16-9-1982 for the acquisition of land at village Bhalwal Tehsil Jammu. The Deputy Commissioner (District Collector) assigned this case to this Collectorate for processing it under the provision of Land Acquisition Act. ~~xxxxxxx~~ Consequently notification under section 4 of the Land Acquisition Act was issued vide this Collectorate No. 9/Asp of 1982 dated 1-10-1982 inviting objections from the concerned land owners/interested persons with regard to acquisition of land measuring 84 kanals 2 marlas comprising khasra No. 2652, 2654, 2649, 2740, 2741, 2745, 2747 and 2750 situate at village Bhalwal Tehsil Jammu for Rashtriya Sanskrit Sansthan. In response to said Notification the owners/interested persons in the land have raised no objection with regard to acquisition of the subject land.

Subsequently the Secretary to Government Revenue Department Jammu was requested vide this office letter No. 7/LJ/82-83/797 dated 25-11-1982 for issuance of notification u/s 6 of the Act with directive under section 7 of the Act. The Deputy Secretary to Government Revenue Department issued notification under section 6 and 7 of the Act under No. RD-89 of 1984 copy received under No. Rev(LAJ)143/82 dated 18-5-1984. The Deputy Secretary to Government Revenue Department vide his letter No. Rev(LAJ)143/82 dated 8-2-1985 has also intimated that the Cabinet vide decision No. 114 dated 26-4-84 has approved the acquisition of land for the Rashtriya Sanskrit Sansthan in village Bhalwal and on that basis ~~xxx~~ declaration vide RD-89 dated 18-5-1984 has been issued by the Adm. Department.

After issuance of notification under section 6 and 7 of the Act notices u/s 9 and 9-A were served upon the land owners/interested persons in the land, Custodian Evacuee Property Jammu and Indenting Department for filing their objections, if any about the nature of the irrelative interests in the land and the amount and particulars of their claim to compensation for such interest. In response to said notices the following applications have been received:

- 1) Application of Lachman Singh, Isher Dass, Chet Ram and others dated 25-6-1984 and demanded the rate of land @ Rs. 4000/- per kanal. Their statement have also been recorded.
- 2) Application of Swaran Singh s/o Kanchi Ram, Jaiul Singh s/o Sukh Singh, Joginder Singh s/o Budhi Singh, Sagar Singh s/o Man Singh, Mohiwar s/o Chail Singh and Kartar Singh s/o Sain Singh through Kartar Singh and demanded the rate of land of @ Rs. 7000/- per kanal.

In support of their claim they have produced following documents:-

- 1) Copy of mutation No. 2191 of village Bhalwal Tehsil Jammu in respect of sale of land measuring 40 kanals 19 marlas of village Bhalwal Tehsil Jammu (sale deed of 28-5-1982) in favour of Payara Lal Saraf s/o L. Dewan Chand Saraf.

*attested true copy*

*[Signature]*

DIRECTOR  
श्री श्री संस्कृत विश्वविद्यालय  
CENTRAL SANSKRIT UNIVERSITY  
श्री श्री संस्कृत विश्वविद्यालय के अध्यक्ष  
New Delhi, India (जम्मू संस्करण)

*Handwritten notes and signatures in the left margin.*



(R for - 2/2/84) Jammu in consideration of Rs. 1,21,850/- i.e. Rs. 2975/- P.K.

Copy of sale deed dated 17-12-1981 in respect of land measuring 1 kanal 2 mls situated at village Bahawal Tehsil Jammu made by Prathi Singh S/O Kom Singh in consideration of Rs. 7000/- i.e. Rs. 6363-60 per kanal.

The Custodian Evacuee Property Jammu vide his letter No. B-84/MP-143 dated 31-7-1984 has demanded the rate of land of Rs. 40,000/- (Forty thousand per kanal. From the-indenting Department the Principal Sri Ranbir Kunderiya Sanskrit Vidya Peeth Jammu vide his letter No. RSV/20012/84-85/927 dated 26-6-84 has intimated that rate of land fixed by this Collectorate will be acceptable to him.

The Tehsildar Jammu vide his report No. 398/OQ dated 26-5-1982 has intimated the market rate of land @ Rs. 1500/- per kanal.

I have inspected the land under acquisition on 2-4-1985 in the presence of Shri Bachpal Singh Naib Tehsildar Jammu and Principal Sri Ranbir Kunderiya Sanskrit Vidya Peeth Jammu and some land owners/interested persons in the land. Patwari Halqa who was also present on spot had been directed to furnish the average sale rate of land in the area and he has furnished the same and perusal of which it appears that average sale rate of <sup>land</sup> comes to Rs. 2737/- per kanal.

Keeping in view the facts mentioned above the location of the land, date of Notification under section 6 of the Act i.e. 16-5-1984 and rising trend of prices I think the rate of land @ Rs. 2700/- per kanal is reasonable for adoption in this case. The acquisition being compulsory Jabrana @ 15% is also allowed. Accordingly the amount of compensation works out as under:-

S.No.	Area	Soil of lands	Rate Per Kanal	Cost of land.	Jabrana @ 15%	Total amount compensation.
1.	79k-4a	Warhal I & II	2700/-	2,27,080/-	34060-50	2,61,130-50
2.	4k-18a	Chair Munkin				
	84k-02a					

There are 23 Fruit bearing trees falling under khasra numbers 2746, 2741, 2740, 2654 in the proposed acquisition case. The assessment of fruit bearing tree has been made by the District Horticulture Officer Jammu under his No. 3096/NO dated 19-3-85 which works out to Rs. 20,666.62. All the trees are of the age of more than eight years. As such cost of land three square yards i.e. 1 marla has been deducted from the each fruit tree. The cost of land after deducting the area under fruit trees is works out as under:-

1. Cost of land measuring 82kanals 19 marla (after deducting the cost of fruit trees 1 kanal 3 marla) = 2,23,968-00
2. Jabrana @ 15% = 33,594-75
3. Cost of Fruit Trees. = 20,666-62
4. Total:- = 2,78,226-37

contd..3rd..

*Attested True Copy*

379  
DIRECTOR  
केन्द्रीय संस्कृत विश्वविद्यालय  
CENTRAL SANSKRIT UNIVERSITY  
भारत सरकार, नई दिल्ली



Handwritten text at the top of the page, likely a title or header in Urdu or Hindi.

Handwritten text below the title, possibly a subtitle or reference.

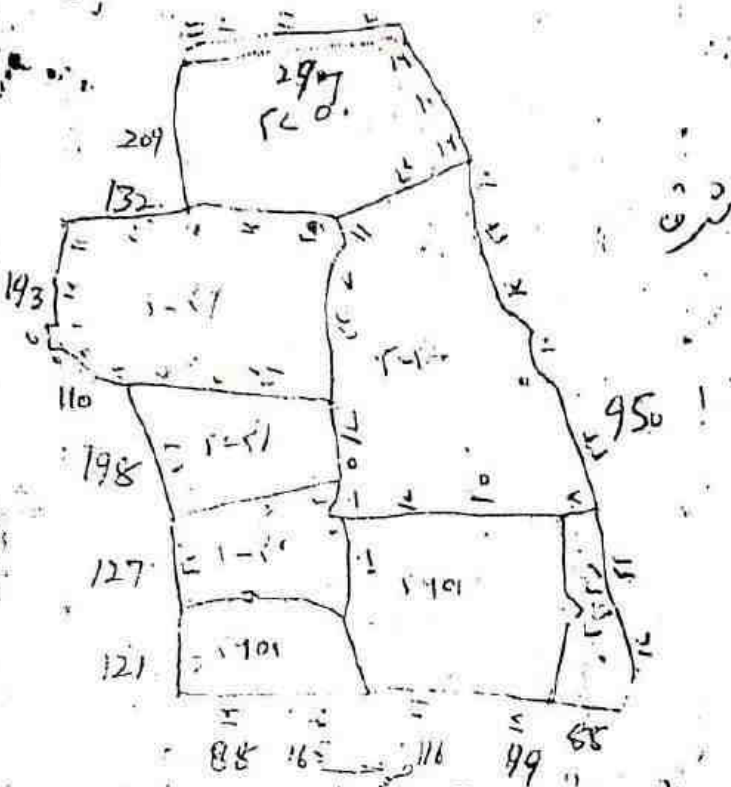

Handwritten text below the diagram, possibly a description or notes related to the parcels.

Handwritten signature or name, possibly 'Chander' or similar.

Attested true copy  
Handwritten signature/initials below the attestation.

Official stamp or seal, partially legible, containing the word 'DIRECTOR'.

Handwritten number '79' and other markings.

Director / Director  
केन्द्रीय संस्कृत विश्वविद्यालय,  
CENTRAL SANSKRIT UNIVERSITY  
भारत नि मन्त्रालय, भारत सरकार के अधीन  
Under MHRD, Govt. of India  
श्री रणवीर प्रसिद, कोट-मलवा, जम् (जम्पूकरगीर)  
JAMMU (J&K)





1. Lachman Singh s/o Shiv Ram  
 equal share (10 shares) Gurm Singh,  
 Singh, Purn Singh, Detan Singh  
 equal share (32 shares)  
 2. Manto Devi, Bindo Devi daughters  
 3. Sarda Devi w/o Poo Singh equal  
 shares (3 shares) dar one share dar 1/4th  
 4. Poo s/o Poo 1/4th, Poo Singh son  
 four shares, Poo, Sarda w/o Sant Ram  
 one share, Bhola Singh, Mohi Singh,  
 Chander Singh 10 equal share (27 shares)  
 5. Poo, Poo, Poo, Poo, Poo, Poo  
 6. Poo, Poo, Poo, Poo, Poo, Poo  
 7. Poo, Poo, Poo, Poo, Poo, Poo  
 8. Poo, Poo, Poo, Poo, Poo, Poo  
 9. Poo, Poo, Poo, Poo, Poo, Poo  
 10. Poo, Poo, Poo, Poo, Poo, Poo  
 11. Poo, Poo, Poo, Poo, Poo, Poo  
 12. Poo, Poo, Poo, Poo, Poo, Poo  
 13. Poo, Poo, Poo, Poo, Poo, Poo  
 14. Poo, Poo, Poo, Poo, Poo, Poo  
 15. Poo, Poo, Poo, Poo, Poo, Poo  
 16. Poo, Poo, Poo, Poo, Poo, Poo  
 17. Poo, Poo, Poo, Poo, Poo, Poo  
 18. Poo, Poo, Poo, Poo, Poo, Poo  
 19. Poo, Poo, Poo, Poo, Poo, Poo  
 20. Poo, Poo, Poo, Poo, Poo, Poo  
 21. Poo, Poo, Poo, Poo, Poo, Poo  
 22. Poo, Poo, Poo, Poo, Poo, Poo  
 23. Poo, Poo, Poo, Poo, Poo, Poo  
 24. Poo, Poo, Poo, Poo, Poo, Poo  
 25. Poo, Poo, Poo, Poo, Poo, Poo  
 26. Poo, Poo, Poo, Poo, Poo, Poo  
 27. Poo, Poo, Poo, Poo, Poo, Poo  
 28. Poo, Poo, Poo, Poo, Poo, Poo  
 29. Poo, Poo, Poo, Poo, Poo, Poo  
 30. Poo, Poo, Poo, Poo, Poo, Poo  
 31. Poo, Poo, Poo, Poo, Poo, Poo  
 32. Poo, Poo, Poo, Poo, Poo, Poo  
 33. Poo, Poo, Poo, Poo, Poo, Poo  
 34. Poo, Poo, Poo, Poo, Poo, Poo  
 35. Poo, Poo, Poo, Poo, Poo, Poo  
 36. Poo, Poo, Poo, Poo, Poo, Poo  
 37. Poo, Poo, Poo, Poo, Poo, Poo  
 38. Poo, Poo, Poo, Poo, Poo, Poo  
 39. Poo, Poo, Poo, Poo, Poo, Poo  
 40. Poo, Poo, Poo, Poo, Poo, Poo  
 41. Poo, Poo, Poo, Poo, Poo, Poo  
 42. Poo, Poo, Poo, Poo, Poo, Poo  
 43. Poo, Poo, Poo, Poo, Poo, Poo  
 44. Poo, Poo, Poo, Poo, Poo, Poo  
 45. Poo, Poo, Poo, Poo, Poo, Poo  
 46. Poo, Poo, Poo, Poo, Poo, Poo  
 47. Poo, Poo, Poo, Poo, Poo, Poo  
 48. Poo, Poo, Poo, Poo, Poo, Poo  
 49. Poo, Poo, Poo, Poo, Poo, Poo  
 50. Poo, Poo, Poo, Poo, Poo, Poo  
 51. Poo, Poo, Poo, Poo, Poo, Poo  
 52. Poo, Poo, Poo, Poo, Poo, Poo  
 53. Poo, Poo, Poo, Poo, Poo, Poo  
 54. Poo, Poo, Poo, Poo, Poo, Poo  
 55. Poo, Poo, Poo, Poo, Poo, Poo  
 56. Poo, Poo, Poo, Poo, Poo, Poo  
 57. Poo, Poo, Poo, Poo, Poo, Poo  
 58. Poo, Poo, Poo, Poo, Poo, Poo  
 59. Poo, Poo, Poo, Poo, Poo, Poo  
 60. Poo, Poo, Poo, Poo, Poo, Poo  
 61. Poo, Poo, Poo, Poo, Poo, Poo  
 62. Poo, Poo, Poo, Poo, Poo, Poo  
 63. Poo, Poo, Poo, Poo, Poo, Poo  
 64. Poo, Poo, Poo, Poo, Poo, Poo  
 65. Poo, Poo, Poo, Poo, Poo, Poo  
 66. Poo, Poo, Poo, Poo, Poo, Poo  
 67. Poo, Poo, Poo, Poo, Poo, Poo  
 68. Poo, Poo, Poo, Poo, Poo, Poo  
 69. Poo, Poo, Poo, Poo, Poo, Poo  
 70. Poo, Poo, Poo, Poo, Poo, Poo  
 71. Poo, Poo, Poo, Poo, Poo, Poo  
 72. Poo, Poo, Poo, Poo, Poo, Poo  
 73. Poo, Poo, Poo, Poo, Poo, Poo  
 74. Poo, Poo, Poo, Poo, Poo, Poo  
 75. Poo, Poo, Poo, Poo, Poo, Poo  
 76. Poo, Poo, Poo, Poo, Poo, Poo  
 77. Poo, Poo, Poo, Poo, Poo, Poo  
 78. Poo, Poo, Poo, Poo, Poo, Poo  
 79. Poo, Poo, Poo, Poo, Poo, Poo  
 80. Poo, Poo, Poo, Poo, Poo, Poo  
 81. Poo, Poo, Poo, Poo, Poo, Poo  
 82. Poo, Poo, Poo, Poo, Poo, Poo  
 83. Poo, Poo, Poo, Poo, Poo, Poo  
 84. Poo, Poo, Poo, Poo, Poo, Poo  
 85. Poo, Poo, Poo, Poo, Poo, Poo  
 86. Poo, Poo, Poo, Poo, Poo, Poo  
 87. Poo, Poo, Poo, Poo, Poo, Poo  
 88. Poo, Poo, Poo, Poo, Poo, Poo  
 89. Poo, Poo, Poo, Poo, Poo, Poo  
 90. Poo, Poo, Poo, Poo, Poo, Poo  
 91. Poo, Poo, Poo, Poo, Poo, Poo  
 92. Poo, Poo, Poo, Poo, Poo, Poo  
 93. Poo, Poo, Poo, Poo, Poo, Poo  
 94. Poo, Poo, Poo, Poo, Poo, Poo  
 95. Poo, Poo, Poo, Poo, Poo, Poo  
 96. Poo, Poo, Poo, Poo, Poo, Poo  
 97. Poo, Poo, Poo, Poo, Poo, Poo  
 98. Poo, Poo, Poo, Poo, Poo, Poo  
 99. Poo, Poo, Poo, Poo, Poo, Poo  
 100. Poo, Poo, Poo, Poo, Poo, Poo

Kartar Singh 2700/-  
 S/O Sain Singh  
 Jaginder Singh s/o  
 Bahi Singh, Jatal  
 Singh s/o Bahi Ram  
 Ram Singh s/o  
 Kanchi Ram in equal  
 share (4 share)  
 Hehar Singh s/o  
 Dasi Singh  
 Singh s/o Ram  
 Singh equal share  
 one share vide  
 No. 2274

1% 2a Bahi 2700/- 1570/- 7750/- 59305/-

-do-  
 -do-  
 -do-

-do- 2750n 5k-5 -do-  
 Isher Dass, 2750n 4k-5 -do-  
 Lachman Singh  
 Ram Singh s/o same  
 equal share share holder  
 -do- 2750n 3k-1 in share  
 Jagbir public share  
 work.

-do- 17415/- 2512-25 - 20927-25  
 -do- 11205/- 1580-75 - 12883-75

Attested True Copy  
 P. K. Singh  
 P. K. Singh  
 P. K. Singh

The Acquittance Note should be prepared strictly  
 according to the instructions and administrative  
 charges may also be deducted under sub-  
 section 10(2)(c) of the Income Tax Act, 1922.  
 Attested True Copy

10. State (Title mutation No. 1449)		Kashit Dhanu s/o Phullo Qasur s/o Dh. non-occupancy Lagan Narsi Kashit Jale Datan	2534 ✓ s-12m	Kashit 2700 124118 Gair mun in s-12m 124-17n	2420/- 1204-25/- 3787/- Nil	the cost of laid out one fruit tree has been produced by not contributing the seed in case now.
11. State		Kashit Dhanu s/o Phullo Qasur s/o Dh. non-occupancy Lagan Narsi Kashit Jale Datan	2534 ✓ s-12m	Kashit 2700 124118 Gair mun in s-12m 124-17n	1020/- 1010/- 1036/-	(2268)
Note: Item No 2650, 2651 is a state land and land is situated in a village of Bilal. This being a non-occupancy land is not contributing the seed in case now. The amount is required to be paid in favour of the State as per the instructions keeping a view to the instructions personally written therefor by the State.						
11. State		2534 ✓ s-12m		223,965/- 33,594-75 28665-52 258,226-37		

- Under the standing instructions of the Government, the following certificates are recorded.
- 1) Funds are available with the Indenting Department to meet the cost of acquisition.
  - 2) The subject land has not been acquired earlier.
  - 3) Payment will not be made if the land escheates to the State.

*Attended*  
*R. P. P. K. S. M.*

**27**  
DIRECTOR  
CENTRAL SANDS  
THE GOVERNMENT OF  
MADRAS  
The requirements here should be prepared strictly according to the instructions and administrative charges may also be deducted under Part II Attended Fee.



Since the amount involved in this case exceeds Rs. 25,000/- the draft for award of land acquisition case was submitted to the Deputy Commissioner Jammu for favour of obtaining the approval of rate proposed under this office No. 7/LA/85/137 dated 28-5-1985. The Deputy Commissioner Jammu vide his letter No. 143/LA dated 7-5-1985 submitted this case to the Divisional Commissioner Jammu for favour of conveying the necessary approval. The Divisional Commissioner Jammu vide his letter No. 502(186)1439-80 dated 24-5-1985 has conveyed the approval to the rate of compensation at Rs. 2700/- per kanal for the land under acquisition.

Therefore, I Narinder Singh Johar, K.S. Collector (Additional Deputy Commissioner) Jammu make the award of compensation amounting to Rs. 2,79,226-37 (two lacs seventy eight thousand two hundred twenty six and paise thirty seven only) in the subject land acquisition case. Notice under section 12(2) of the Land Acquisition Act may be served upon the interested person accordingly. Announced in the presence of interested persons.

Dated 20-7-1985

*[Signature]*  
Collector,  
Adl. Deputy Commissioner,  
Jammu.

NO:- 7/LA/82-83/257-00

Dated:- 20-7-1985

Copy to the :-

1. Director Rashtriya Sanskrit Sansthan - A Ram Kishore Road Civil Line Delhi-110054 with the request that the amount of award may kindly be arranged for disbursement to the concerned interested persons.
2. Divisional Commissioner, Jammu for information.
3. Principal Sri Panbir Kondriya Sanskrit Vidhya Peeth Jammu Jammu 304-A Shastri Nagar Jammu for information.
4. Tehsildar Jammu with the remarks that acquittance roll of the area in question be got prepared ~~in~~ in triplicates and furnished to this office duly verified and authenticated. Moreover the concerned persons may also be informed regarding issuance of the award.

The requirements should be prepared strictly according to the instructions and administrative charges may also be deducted under Bulky. Attested true copy.

20/7/85  
nu-Dat

*[Signature]*  
DIRECTOR  
RASHTRIYA SANSKRIT SANSTHAN  
CENTRAL SANSKRIT UNIVERSITY  
Under Ministry Govt. of India  
Jammu (J&K)



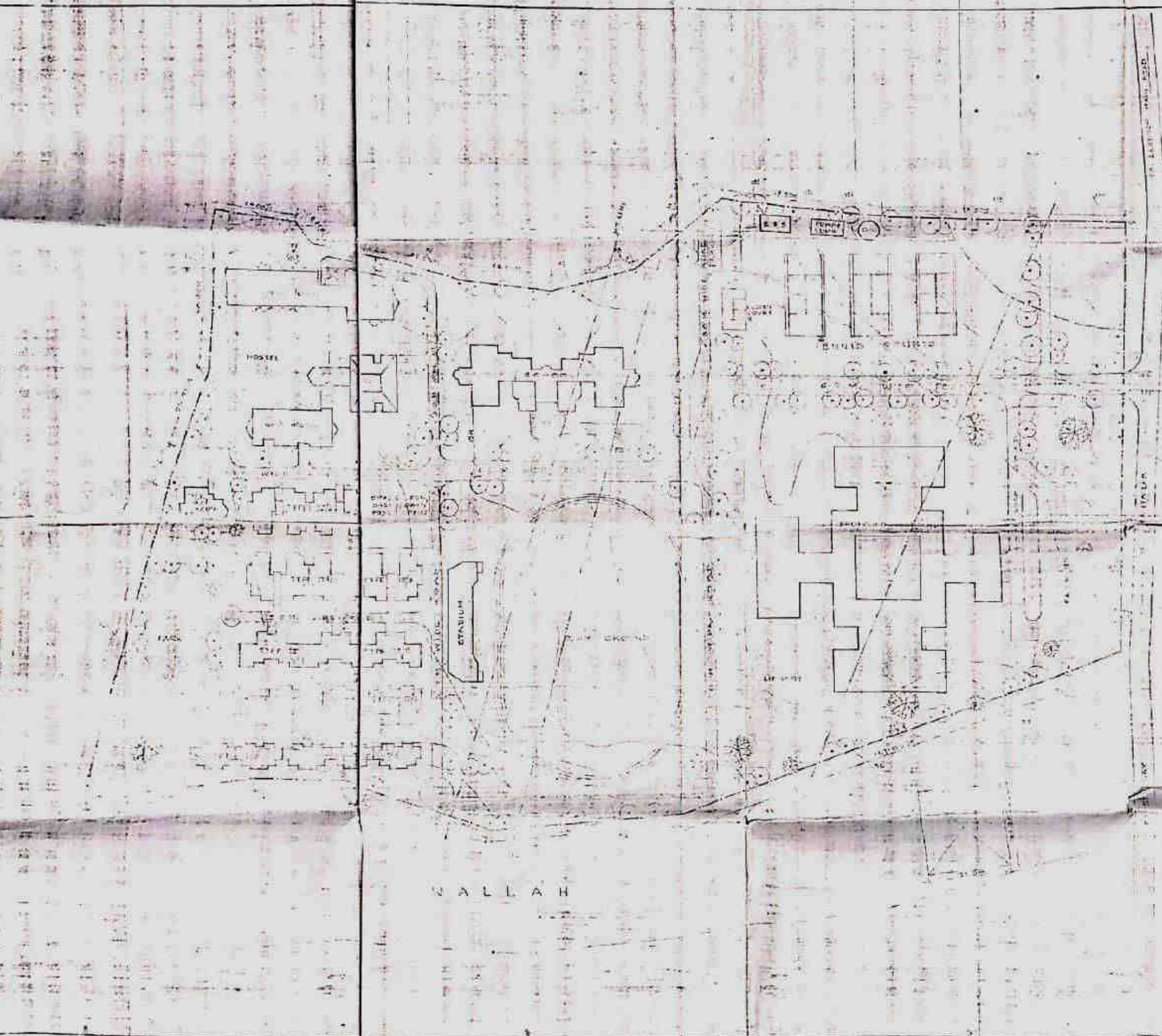

**NOTES**  
 ALL DIMENSIONS ARE IN FEET  
 ALL ARE TO BE PLACED IN THE PROJECT  
 SPEC. CURB & PAVING SHALL BE MATCHED TO JARVIS  
 CENTRAL STATION. ALL CURB WITH 1000 LETTER  
 NO TO BE IN THE 2000 SHALL BE 1000 TO 10

**BREAK UP OF SEATERS**

SEATERS	SEATERS	SEATERS	SEATERS	SEATERS	SEATERS
1	2	3	4	5	6
7	8	9	10	11	12
13	14	15	16	17	18
19	20	21	22	23	24
25	26	27	28	29	30

**REQUIREMENTS**  
 ALL ARE TO BE PLACED IN THE PROJECT  
 ALL ARE TO BE PLACED IN THE PROJECT  
 ALL ARE TO BE PLACED IN THE PROJECT  
 ALL ARE TO BE PLACED IN THE PROJECT

**REVISIONS**

NO.	DATE	DESCRIPTION
1		
2		
3		
4		
5		

**NOTE**  
 ALL ARE TO BE PLACED IN THE PROJECT  
 ALL ARE TO BE PLACED IN THE PROJECT  
 ALL ARE TO BE PLACED IN THE PROJECT  
 ALL ARE TO BE PLACED IN THE PROJECT



GALLAH

NO.	DATE	DESCRIPTION
1		
2		
3		
4		
5		